

\$595,000 - 2503 10360 102 Street, Edmonton

MLS® #E4392522

\$595,000

2 Bedroom, 2.00 Bathroom, 910 sqft
Condo / Townhouse on 0.00 Acres

Downtown (Edmonton), Edmonton, AB

It's not just about the space, it's about the lifestyle! Experience an unparalleled blend of style, comfort and convenience with breathtaking views from this two-bedroom, two-bath suite with two-titled parking stalls. A sought-after split floor plan offers maximum privacy, functionality and sophistication. Located above the JW Marriott hotel, The Legends Private Residences offers world-class amenities, including a pool, hot tub, steam room, conference room, fitness facilities, billiards lounge, rooftop patio with BBQ area, pet walk area, and 24/7 concierge service. Monthly fees cover all amenities, plus heat and water. The convenient Pedway System provides direct access to Rogers Place, LRT, restaurants, and shopping. Redefining elegance, you'll enjoy an elevated level of pampering and personalized attention ensuring that every aspect of your life here is marked by comfort and opulence. Indulge in the luxury of life in the Ice District!

Built in 2017

Essential Information

MLS® #	E4392522
Price	\$595,000
Bedrooms	2
Bathrooms	2.00

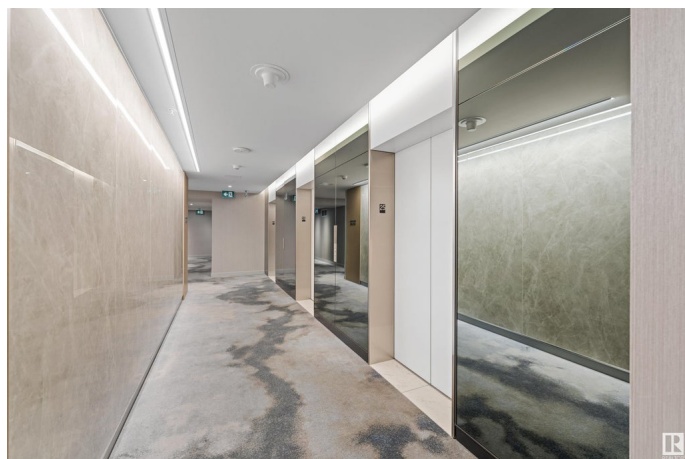

Full Baths	2
Square Footage	910
Acres	0.00
Year Built	2017
Type	Condo / Townhouse
Sub-Type	Apartment High Rise
Style	Single Level Apartment
Status	Active

Community Information

Address	2503 10360 102 Street
Area	Edmonton
Subdivision	Downtown (Edmonton)
City	Edmonton
County	ALBERTA
Province	AB
Postal Code	T5J 0K6

Amenities

Amenities	Air Conditioner, Closet Organizers, Exercise Room, Hot Tub, Parking-Visitor, Party Room, Patio, Pool-Indoor, Sauna; Swirlpool; Steam, Secured Parking, Security Personnel
Parking Spaces	2
Parking	Heated, Parkade, Stall
Has Pool	Yes

Interior

Interior Features	ensuite bathroom
Appliances	Dishwasher-Built-In, Garage Control, Hood Fan, Oven-Built-In, Oven-Microwave, Refrigerator, Stacked Washer/Dryer, Stove-Countertop Electric
Heating	Fan Coil, Natural Gas
# of Stories	54
Stories	1
Has Basement	Yes
Basement	None, No Basement

Exterior

Exterior	Concrete, Metal
----------	-----------------

Exterior Features	Public Transportation, Schools, Shopping Nearby, View City, See Remarks
Roof	EPDM Membrane
Construction	Concrete, Metal
Foundation	Concrete Perimeter

Additional Information

Date Listed	June 13th, 2024
Days on Market	295
Zoning	Zone 12
Condo Fee	\$1,299

DATA IS DEEMED RELIABLE BUT IS NOT GUARANTEED ACCURATE BY THE REALTORS® ASSOCIATION OF EDMONTON. COPYRIGHT 2025 BY THE REALTORS® ASSOCIATION OF EDMONTON. ALL RIGHTS RESERVED. Trademarks are owned or controlled by the Canadian Real Estate Association (CREA) and identify real estate professionals who are members of CREA (REALTOR®, REALTORS®) and/or the quality of services they provide (MLS®, Multiple Listing Service®)

Listing information last updated on April 4th, 2025 at 9:18am MDT