

\$188,000 - 9348 105 Avenue, Edmonton

MLS® #E4380515

\$188,000

0 Bedroom, 0.00 Bathroom,
Land Commercial on 0.00 Acres

Boyle Street, Edmonton, AB

VACANT LOT. 10.1M X 37.2M OR 33 ft x 122 ft. or 4,026 sq. ft. Central location; close to all amenities City Centre has to offer. Close to residential Highrise buildings. THIS IS A CORNER LOT; AS THE LOT 9352 IS PART OF THE CITY OF EDMONTON ROADWAY FOR THEIR SHOPS. Walking distance to River Valley and trials; also to City Centre which includes Roger Place, Ice District.

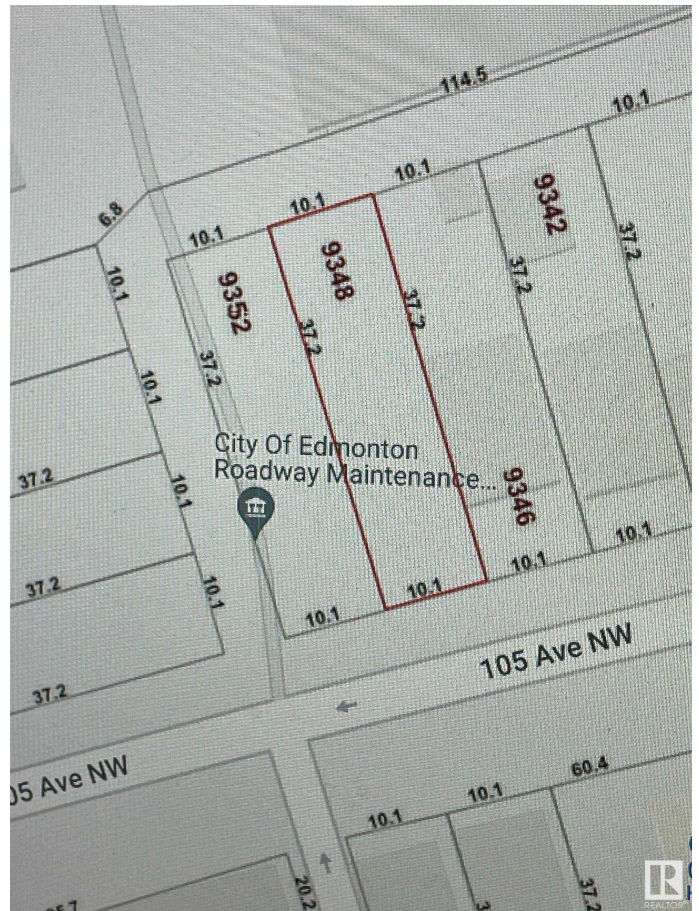

Essential Information

MLS® #	E4380515
Price	\$188,000
Bathrooms	0.00
Acres	0.00
Type	Land Commercial
Status	Active

Community Information

Address	9348 105 Avenue
Area	Edmonton
Subdivision	Boyle Street
City	Edmonton
County	ALBERTA
Province	AB
Postal Code	T5H 0J6

Additional Information

Date Listed April 5th, 2024
Days on Market 363
Zoning Zone 13



DATA IS DEEMED RELIABLE BUT IS NOT GUARANTEED ACCURATE BY THE REALTORS® ASSOCIATION OF EDMONTON. COPYRIGHT 2025 BY THE REALTORS® ASSOCIATION OF EDMONTON. ALL RIGHTS RESERVED. Trademarks are owned or controlled by the Canadian Real Estate Association (CREA) and its member real estate professionals who are members of CREA (REALTOR®/REALTORS®) and/or the quality of services they provide (MLS®/Multiple Listing Service®)

Listing information last updated on April 3rd, 2025 at 5:02pm MDT

